

County Road 48 Reconstruction & Village of Havelock Master Drainage Study

Ontario Street, Quebec Street, George Street E. and Mary Street



PROJECT OVERVIEW

Jewell Engineering Inc. has been retained by The County of Peterborough and The Township of Havelock-Belmont Methuen to initiate Preliminary and Detailed Designs for the Reconstruction of County Road 48, along with the completion of a Master Drainage Plan Study for the Village of Havelock.

The project will proceed and advance in accordance with the latest edition of the Municipal Engineers Association Class Environmental Assessment Manual.

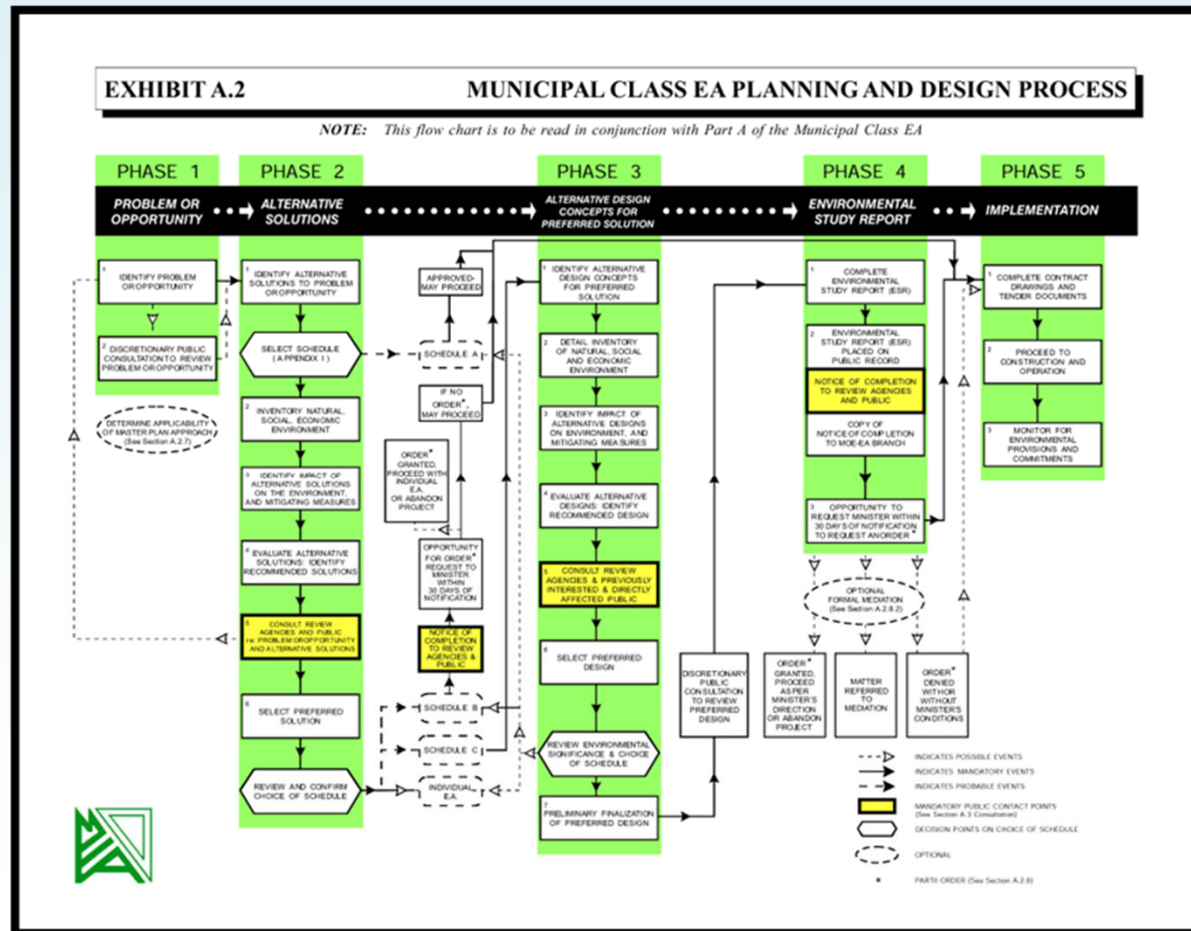

TOWNSHIP OF
HAVELOCK - BELMONT - METHUEN
INC. 1998



Peterborough
County



PURPOSE OF PUBLIC INFORMATION CENTRE

County Road 48 Reconstruction:

- To present Preliminary Designs for the Reconstruction of County Road 48
- To receive feedback from the Residents and Businesses on Preliminary Designs
- To reconstruct the Road Platform and Storm Water Drainage System
- To reconstruct the Sanitary Sewer, Drinking Water and Fire Protection Systems
- To advance Phase 1 to construction in 2024
- To plan for implementation of Phases 2 and 3

Village of Havelock Master Drainage Study

- To identify Drainage Areas and shortfalls with Existing Drainage Network
- To develop Drainage solutions to address Deficiencies, Flood Mitigation, Public Safety and Improve Maintenance
- To assist with Long Term Planning
- To develop a Phased Construction Plan for a new Trunk Storm Sewer and Storage System
- To consider alternative Funding Mechanisms







PRELIMINARY DESIGN CONCEPTS

RECONSTRUCTION OF COUNTY ROAD 48



Preliminary Construction Phasing Plans

-  Phase 1A: Quebec Street – George Street E. to Ottawa Street (Hwy 7) - 2024
-  Phase 1B: George Street E. – Quebec Street to Mathison Street - 2024
-  Phase 2: George Street E. – Mathison Street to Mary Street;
Mary Street – George Street E. to Ottawa Street (Hwy 7) – Timing T.B.D.
-  Phase 3: Ontario Street – Concession Street to Quebec Street – Timing T.B.D.

(The Proposed Phasing and Final Construction sequencing is subject to both the County and Township budget and Council Approvals)



PHASE 1a – QUEBEC STREET

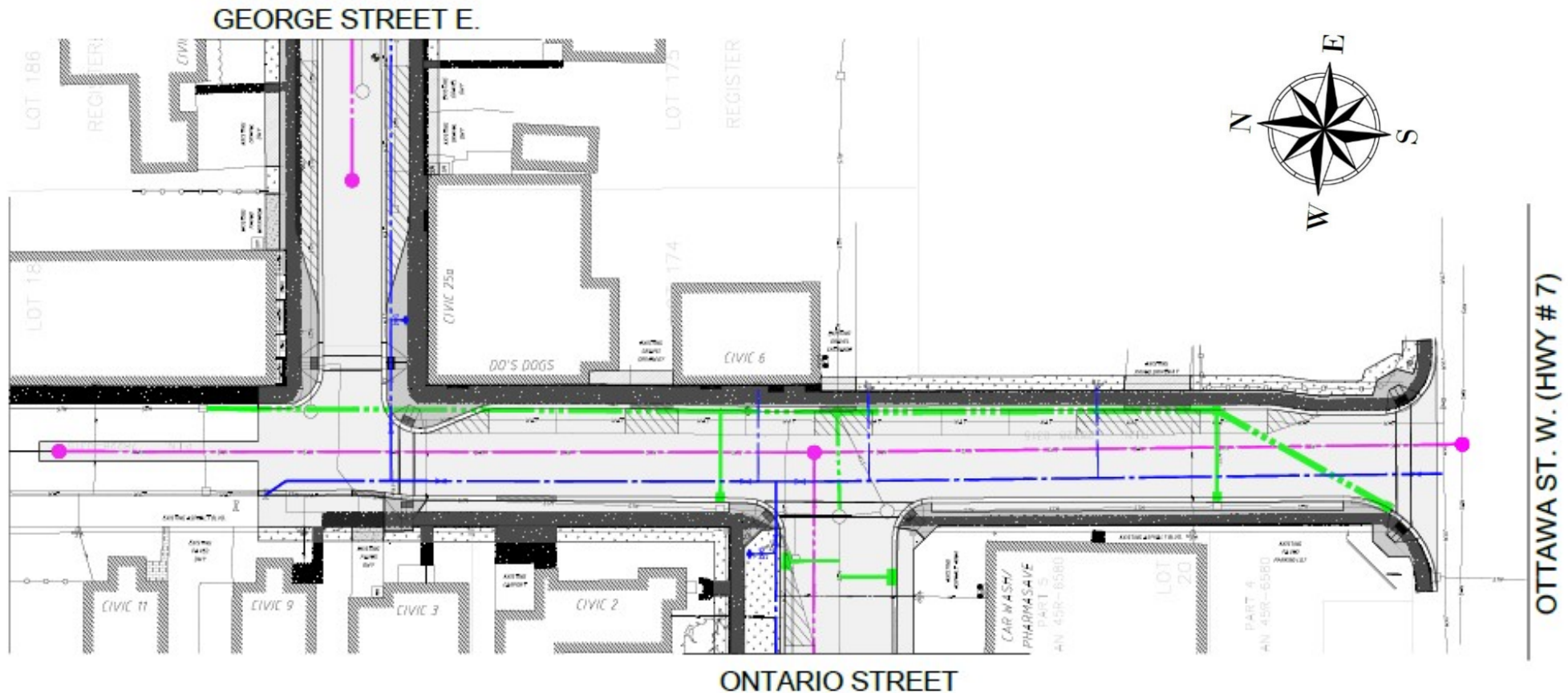

QUEBEC STREET (GEORGE STREET E. TO OTTAWA STREET)

- 3.25m wide Travel Lane Widths
- 2.5m wide Parking (Located on the East Side)
- 1.5m wide New Concrete Sidewalk (Located on the East and West Side)
- New Concrete Curb and Gutter
- New Watermains
- New Sanitary Sewers
- New Storm Sewers & Catch Basins

(Currently Scheduled for Reconstruction in 2024)



PHASE 1a – QUEBEC STREET



LOOKING NORTH



LOOKING SOUTH

EXISTING CONDITIONS

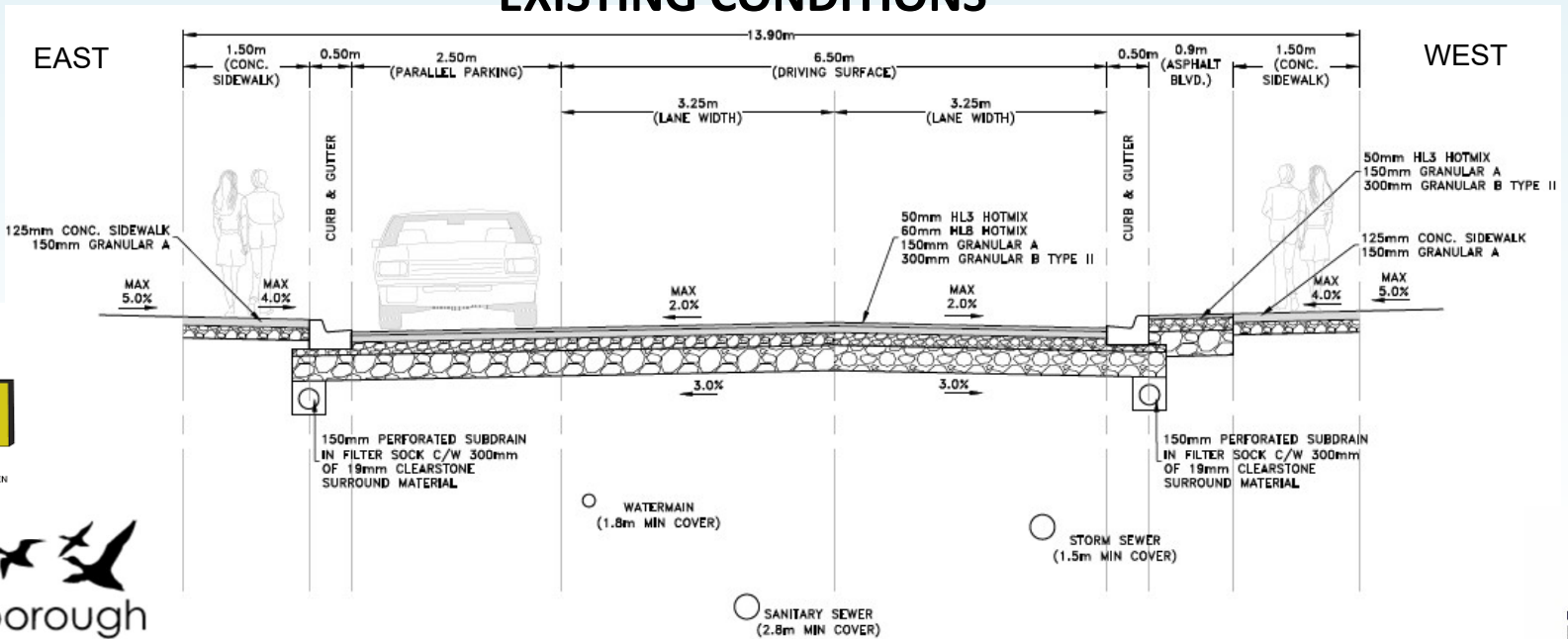

PROPOSED ROAD CROSS SECTION



PHASE 1b – GEORGE STREET E.

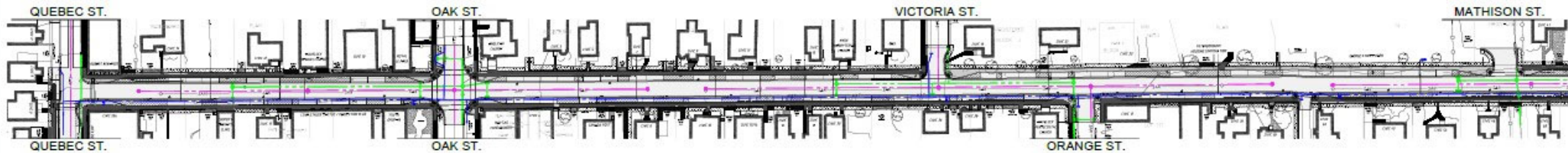

GEORGE STREET E. (QUEBEC STREET TO MATHISON STREET)

- 3.0m wide Travel Lane Widths
- 2.4m wide Parking (Located on the North and South Side)
- 1.5m wide New Concrete Sidewalk (Located on the North and South Side)
- New Concrete Curb and Gutter
- New Watermains
- New Sanitary Sewers
- New Storm Sewers & Catch Basins

(Currently Scheduled for Reconstruction in 2024)

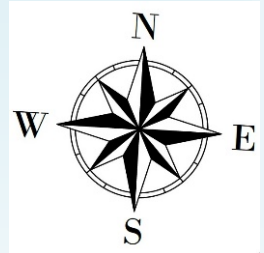

PHASE 1b – GEORGE STREET E.



LOOKING EAST



LOOKING EAST

EXISTING CONDITIONS

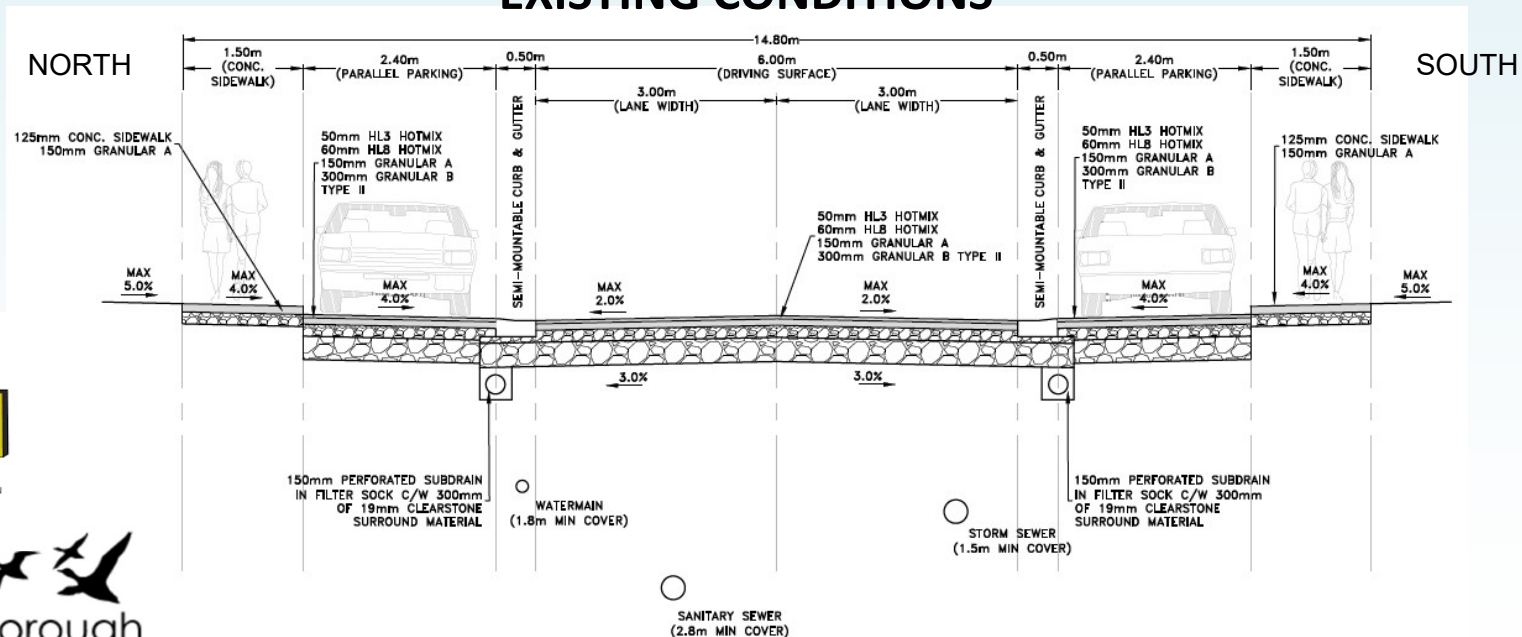

PROPOSED ROAD CROSS SECTION



PHASE 2 – GEORGE STREET E.

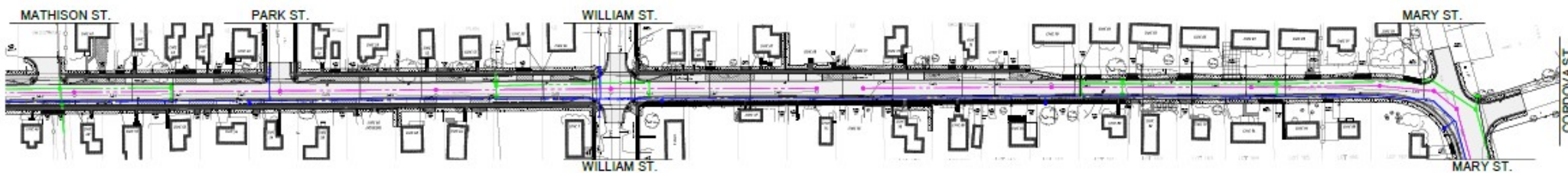

GEORGE STREET E. (MATHISON STREET TO MARY STREET)

- 3.0m wide Travel Lane Widths
- 2.4m wide Parking (Located on the North Side to Civic 79; South Side to William Street)
- 1.5m wide New Concrete Sidewalk (Located on the North Side to Civic 78; continuous along the South Side of the Street)
- New Concrete Curb and Gutter
- New Watermains
- New Sanitary Sewers
- New Storm Sewers & Catch Basins

(Timeline for Reconstruction to be Determined)

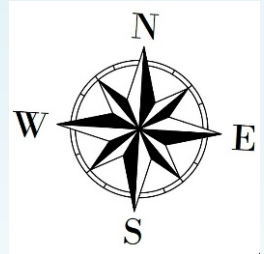

PHASE 2 – GEORGE STREET E.



LOOKING EAST



LOOKING EAST

EXISTING CONDITIONS – GEORGE STREET E.

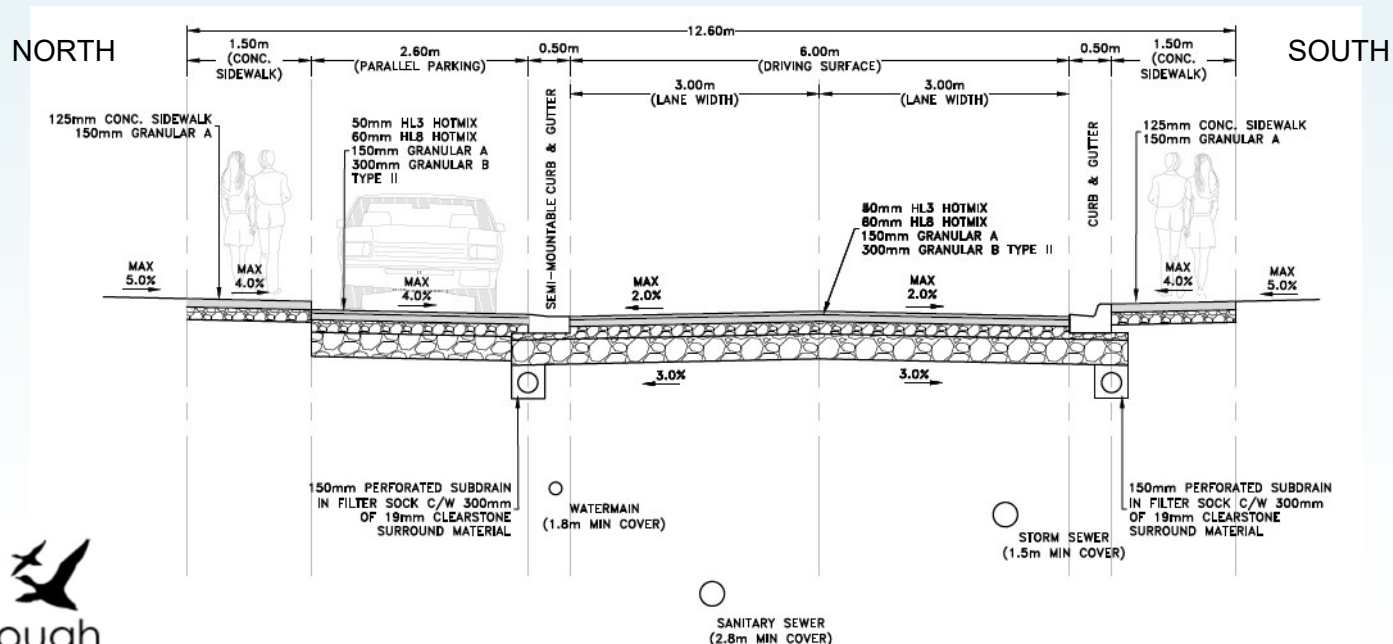

PROPOSED ROAD CROSS SECTION – GEORGE STREET E.



PHASE 2 – MARY STREET

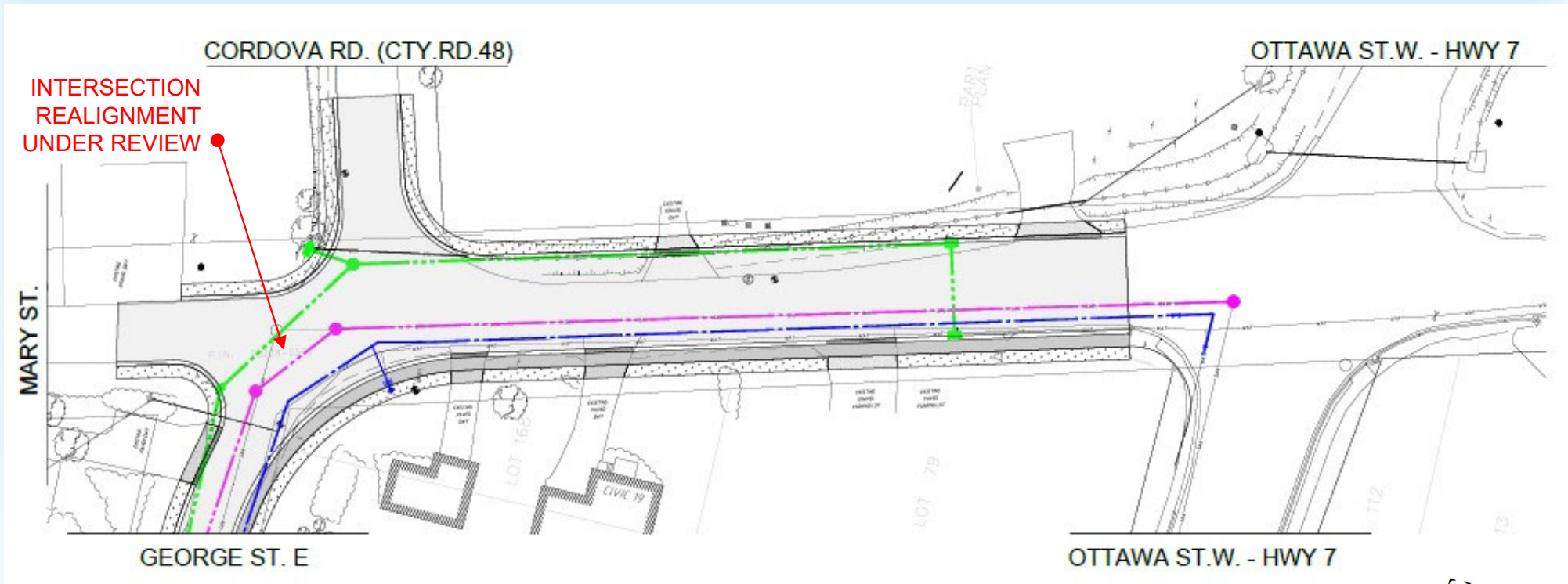

MARY STREET (GEORGE STREET E. TO OTTAWA STREET)

- 5.5m wide Travel Lane Widths
- 1.5m wide New Concrete Sidewalk (Located on the West Side)
- New Concrete Curb and Gutter
- New Watermains
- New Sanitary Sewers
- New Storm Sewers & Catch Basins

(Timeline for Reconstruction to be Determined; Highway 7 and Mary Street Intersection are not included in the Scope of Work)

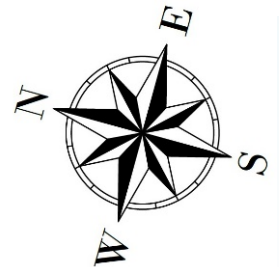

PHASE 2 – MARY STREET



LOOKING NORTH



LOOKING SOUTH

EXISTING CONDITIONS – MARY STREET

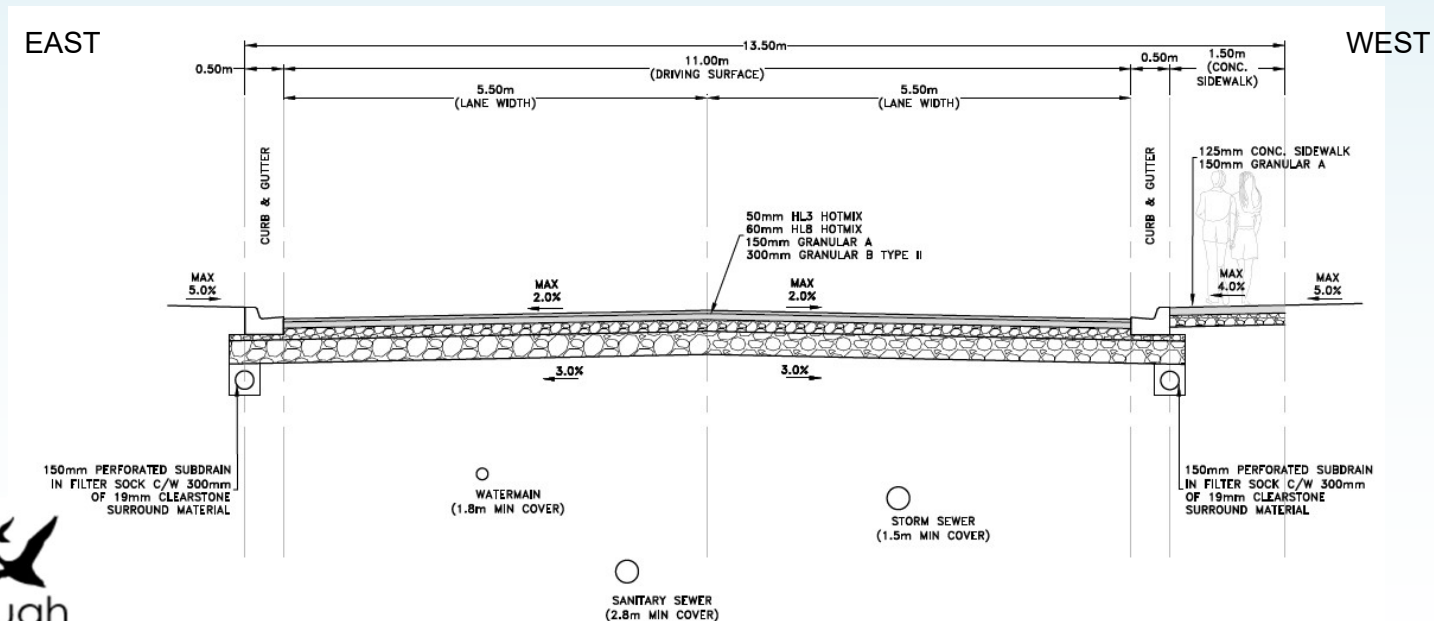

PROPOSED ROAD CROSS SECTION – MARY STREET



PHASE 3 – ONTARIO STREET

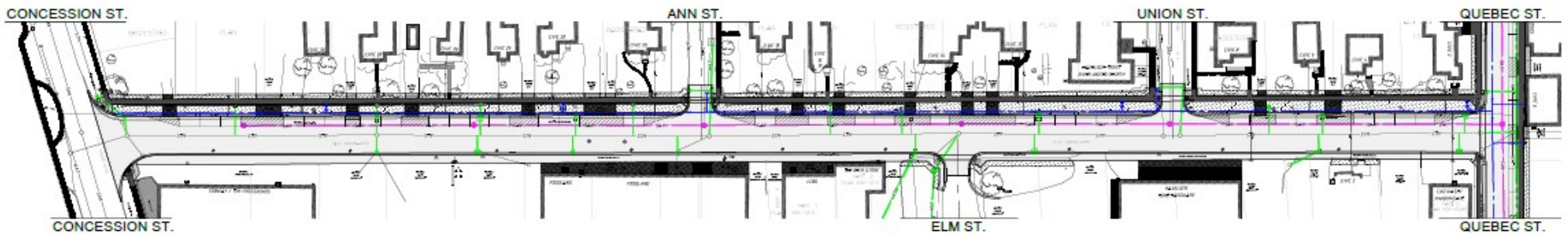

ONTARIO STREET (CONCESSION STREET TO QUEBEC STREET)

- 4.0m wide Travel Lane Widths
- 2.4m wide Parking (Located on the North Side)
- 1.5m wide New Concrete Sidewalk (Located on the North Side)
- New Concrete Curb and Gutter
- New Watermains
- New Sanitary Sewers
- New Storm Sewers & Catch Basins

(Timeline for Reconstruction to be Determined)

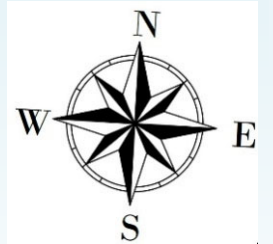

PHASE 3 – ONTARIO STREET



LOOKING EAST



LOOKING EAST

EXISTING CONDITIONS

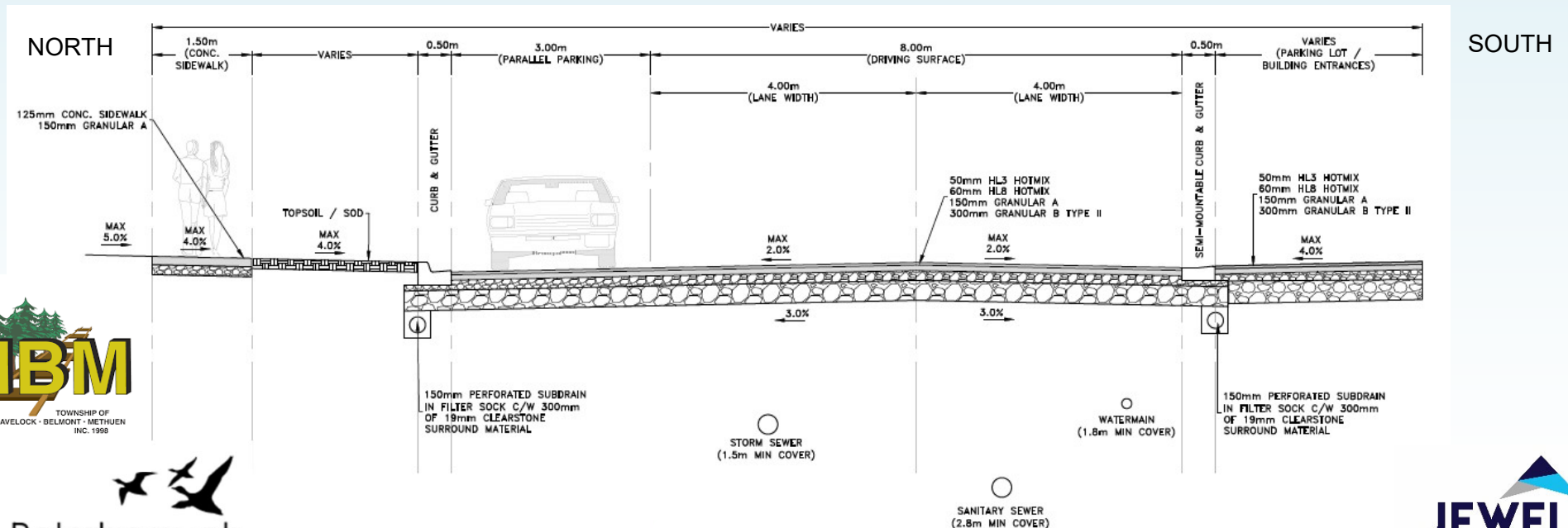

PROPOSED ROAD CROSS SECTION



STREETSCAPE ENHANCEMENTS

CONCRETE RETAINING WALLS



DECORATIVE INTERSECTIONS



VILLAGE OF HAVELOCK MASTER DRAINAGE STUDY



1. Currently the designs for County Road 48 Reconstruction efforts and Master Drainage Plan for the Village of Havelock is being undertaken, which will identify system deficiencies and develop solutions and/or alternate options for improvements.
2. The current Drainage System is located within private properties and found to be in poor condition.
3. The Village has (3) existing Drainage Outlets:
 - a) Location 'A' is located at the South end of Quebec Street, which crosses below the railway lines to the South and discharges to Wetlands.
 - b) Locations 'B' is approximately 400m West of Mary Street
 - c) Location 'C' is approximately 150m West of Mary Street

REAR YARD STORM SEWER



- - - - R-plan available
- - - - No R-plan



NEXT STEPS IN THE PROJECT

County Road 48 Reconstruction

- Receive and Review Public Comment
- Finalize Design of Phase 1 and advance to Construction in 2024
- Review potential Sidewalk Encroachment with Property Owners (#19, #21, #23, #25, #37 George St. E)
- Develop implementation plan for Phase 2 and 3
- Continue discussions with MTO regarding Highway 7/Mary Street intersection improvements

Village of Havelock Master Drainage Study

- Receive and Review Public Comment
- Conduct assessment of Plato Creek wetland
- Develop design concepts of potential drainage improvements
- Consider rebuild of Rear Yard Storm Sewer and potential easement requirements (see Slide 17)
- Consider new storm sewer alignment, pumping station and/or storm water storage facility
- Develop implementation plan
- Report to Council

